

P 型磁芯 Cup Core(Pot Type)

用途：IFT.,RF.,OSC.等用电感器(标准型，P2型需与DR型磁芯或TH型磁芯配对使用)。

APPLICATIONS: INDUCTOR OF IFT.,RF.,OSC.etc.(STANDARD TYPE, P2 TYPE PAIR TO DR CORE or TH CORE WHEN IN USING)

ORDERING CODE:

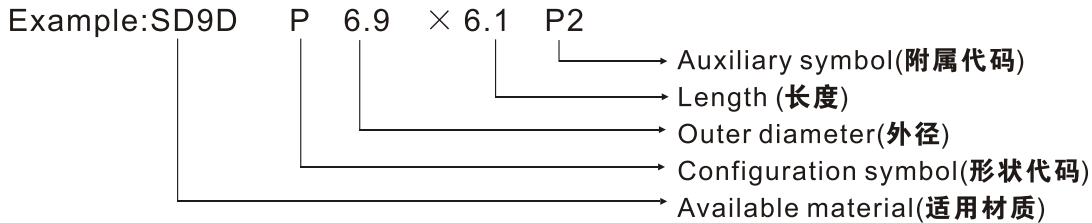

CONFIGURATIONS:

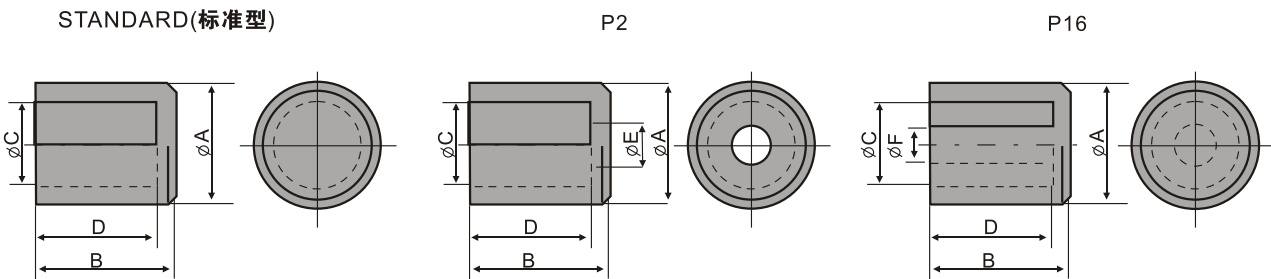

DIMENSION OF MAIN PRODUCTIONS:

UNIT:mm

Ordering code	A	C	B	E	D	F
P9 × 11.5	9.0 ^{+0.15} _{-0.2}	7.3 ± 0.15	11.5 ± 0.45		10.5 ⁺⁰ _{-0.4}	
P10 × 14	10.0 ± 0.3	8.3 ± 0.15	14.0 ± 0.4		12.3 ± 0.2	
P6.9 × 6P2	6.9 ^{+0.15} _{-0.2}	5.5 ± 0.15	6.0 ± 0.2	4.1 ± 0.15	4.7 ^{+0.1} _{-0.15}	
P9.85 × 4.25P2	9.85 ⁺⁰ _{-0.2}	8.3 ± 0.15	4.25 ± 0.2	4.7 ± 0.15	4.7 ± 0.15	
P9.85 × 6.6P2	9.85 ⁺⁰ _{-0.2}	8.1 ^{+0.25} _{-0.05}	6.6 ± 0.2	4.5 ^{+0.25} _{-0.15}	5.2 ± 0.15	
P12.4 × 12P2	12.4 ^{+0.1} _{-0.4}	10.0 ^{+0.2} _{-0.1}	12.0 ± 0.4	5.0 ^{+0.2} ₋₀	10.5 ⁺⁰ _{-0.4}	
P6.9 × 5.2P2	6.9 ^{+0.15} _{-0.2}	5.5 ± 0.15	5.2 ± 0.2	3.5 ± 0.15	4.05 ^{+0.1} _{-0.15}	
P7.8 × 5.8P16	7.8 ± 0.2	6.25 ± 0.15	5.8 ± 0.2		4.8 ± 0.15	2.4 ± 0.1
P9.2 × 9.4P16	9.2 ^{+0.33} _{-0.30}	7.2 ± 0.2	9.4 ± 0.25		7.6 ± 0.25	3.4 ^{+0.10} _{-0.15}
P13.2 × 12P16	13.2 ± 0.25	11 ± 0.2	12.0 ± 0.3		5.5 ± 0.15	5.0 ^{+0.10} _{-0.15}